



J-Lock Clip

For Signaline Linear Heat Detectors



Compatible with Signaline HD+, FT-EN & FT
Suitable for EN54 Installations
Cost-effective
Galvanised steel construction

Fire
detection



Signaline





Model	Signaline J-Lock Clip
Dimensions	50mm x 10mm x 109mm
Pack size	100 clips per pack.
Pack weight	approx. 0.8kg
Mounting	Single screw
Material	Clip: Galvanised steel Cable sleeve: Silicone
Colour	Grey

The J-Lock clip is a single piece of moulded steel that secures Signaline Linear Heat Detection to a flat surface while allowing the correct airflow around the line-type heat detector to ensure compliance with EN54.

The J-Lock is unique in it's design, due to the spring loaded 'lock' that secures the line-type heat detector in place without the need for a cable tie. Thereby reducing waste and decreasing installation time.

Pack includes 100 pcs clips and 100 pcs silicone sleeves.

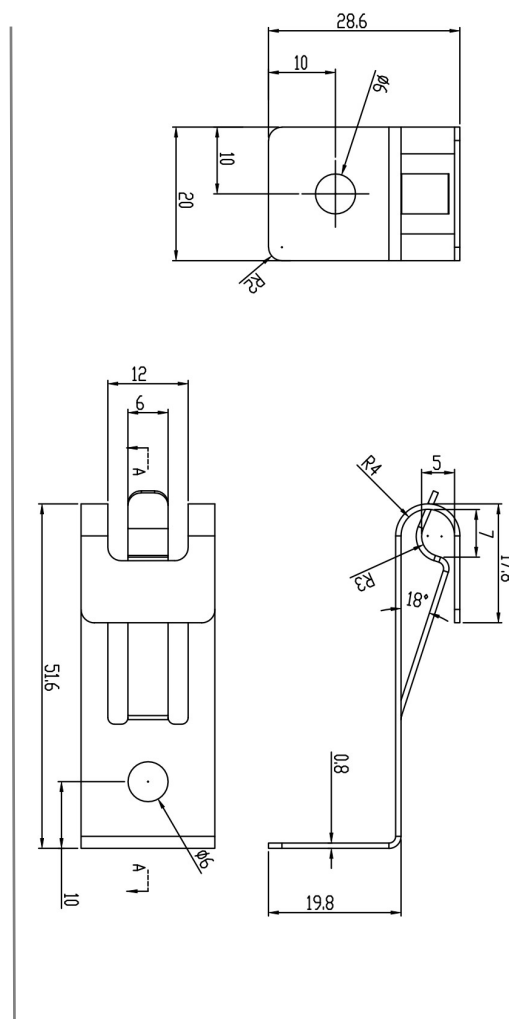

Visit Signaline.com for our full range of heat detection solutions